

Maintenance, Cleaning and Safety Information

Safety Warnings (Highchair mode):

WARNING: Never leave the child unattended.

WARNING: Always use the restraint system.

WARNING: Do not use the product until the child can sit unaided.

Safety Warnings (Booster seat mode):

WARNING: Always use the restraint system and ensure it is correctly fitted.

WARNING: Always use the chair attachment system and ensure it is correctly fitted before use.

WARNING: Do not use this product on stools or benches.

WARNING: Ensure that the adult chair with the booster seat is placed in a position where the child is not able to use its feet to push against a table or any other structure as can cause the adult chair supporting the booster seat to tip over.

Safety Warnings (Stool mode):

WARNING: DO NOT place this product near a window as it can be used as a step and cause the child to fall out if the window.

WARNING: DO NOT place this product near a window where cords from blinds or curtains could strangle a child.

WARNING: The restraint system must be removed in stool mode.

Safety Warnings (All modes):

WARNING: Falling hazard: Prevent your child from climbing on the product.

WARNING: Do not use the product unless all components are correctly fitted and adjusted. WARNING: Be aware of the risk of open fires and other sources of strong heat in the vicinity of the product.

WARNING: Be aware of the risk of tilting when your child can push its feet against a table or any other structure.

WARNING: Keep children away when unfolding and folding the product to avoid injury.

Cleaning:

Metal Parts: Wipe with a damp cloth and dry with a soft cloth.

Harness: Clean with a mild soap and water solution, then rinse and dry.

Plastic Parts: Use a mild soap and water solution; rinse and dry thoroughly.

Caution: Do not use abrasive cleaners or bleach. The tray is not dishwasher safe.

Maintenance:

Inspect Regularly: Do not use the product if any part is broken, torn or missing. Tightness: Regularly inspect all studs, nuts, and screws for tightness, and ensure that all straps and harness points are in good condition.

Replacement Parts: Only use replacement parts approved by the manufacturer. Using unapproved parts may void your warranty.

Manufactured By: The Red Kite Baby Co Ltd, 35 Lavenham Road, Beeches Industrial Estate, Yate, Bristol, BS37 5QX, UK.

Authorised Representative: Mumn Me. Triqis-Suq, Zejtun, ZTN1420, Malta

red kite

IMPORTANT! READ CAREFULLY AND KEEP FOR FUTURE REFERENCE

Instruction leaflet

Feed Me Orbit

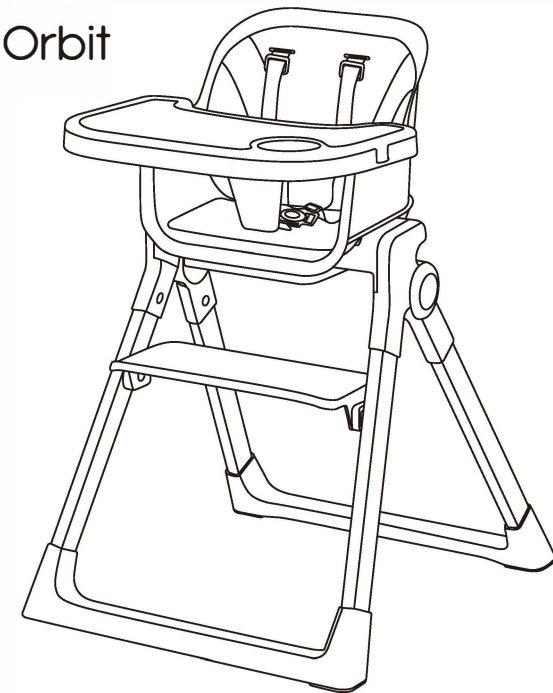

BS EN 14988:2017+A2:2024, BS EN 16120:2012+A2:2016 & BS EN 17191:2021

HIGHCHAIR MODE: This product is intended for children able to sit up unaided and up to 3 years or a maximum weight of 15 kg.

BOOSTER MODE: This product is intended for children able to sit unaided (minimum 6 months) and up to 36 months or a maximum weight of 15 kg.

STOOL MODE: Suitable for children over 3 years up to a maximum weight of 75 kg.

Customer Care: www.redkitebaby.com

Parts List

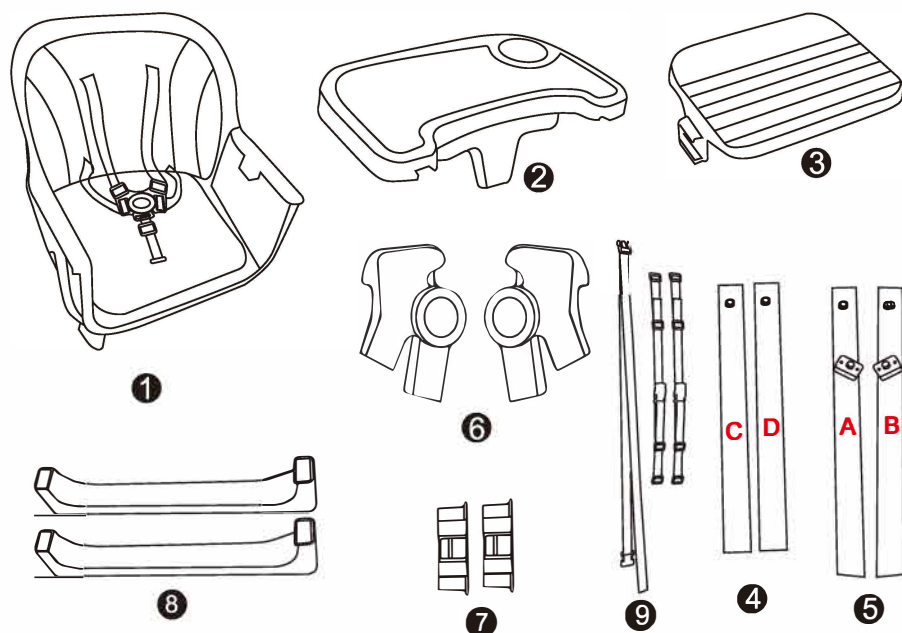

No.	Name	Qty
1	Seat Body	1
2	Tray	1
3	Footplate	1
4	Rear Leg (Left & Right)	2
5	Front Leg (Left & Right)	2
6	Folding Joints	2
7	Seat Clasp	2
8	Foot	2
9	Booster Chair Safety Belt	3

Assembly Instructions

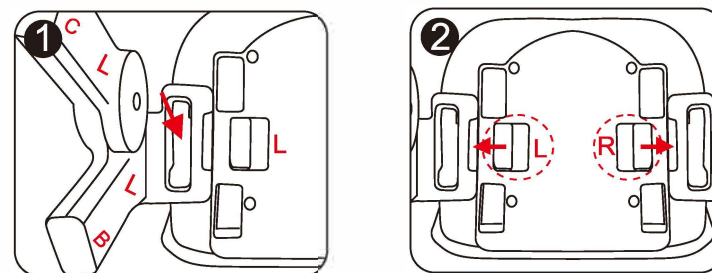

1. Install the seat body by aligning the "R" and "L" markings on the bottom with the corresponding folding joints. Ensure the side with letter markings faces inward during installation.
2. Confirm that the bottom buttons of the seat body have locked the folding joints in place.

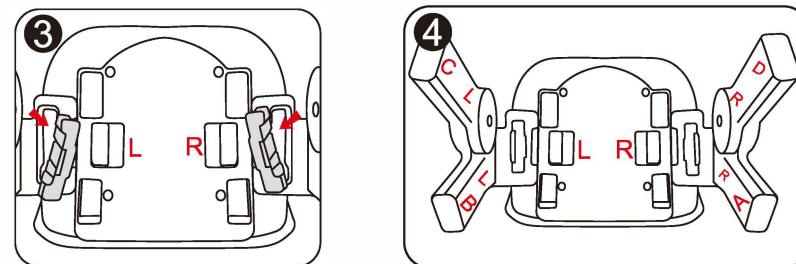

3. Insert the seat clasps into the bottom of the seat to secure the folding joints.
4. Folding joint installation completed.

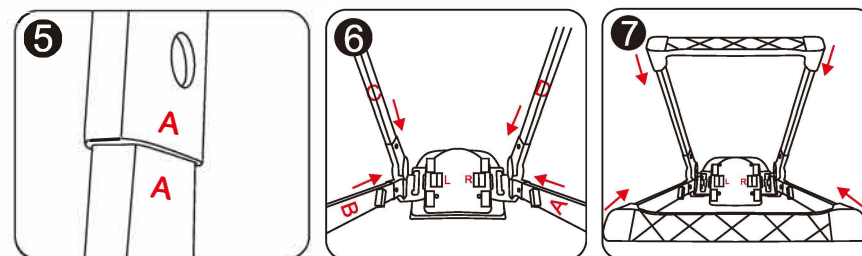

5. Insert the leg marked with a letter into the corresponding folding joint with the matching letter.
6. Leg installation completed.
7. Insert the foot into the front and rear legs respectively.

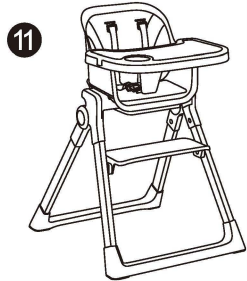
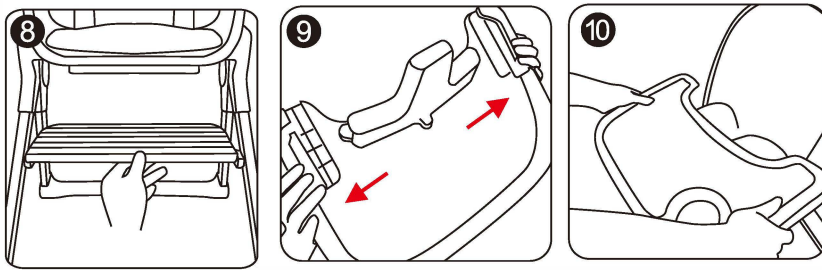

8. Insert the footplate.
 9. Press down both buttons at the bottom of the tray with two hands.
 10. Insert the tray into the seat.
 11. Highchair mode complete.
- Highchair mode: Suitable for children able to sit up unaided and up to 3 years or a maximum weight of 15 kg.

Features and Mode Conversion

1. Simple fold for storage

Press the folding buttons to fold.

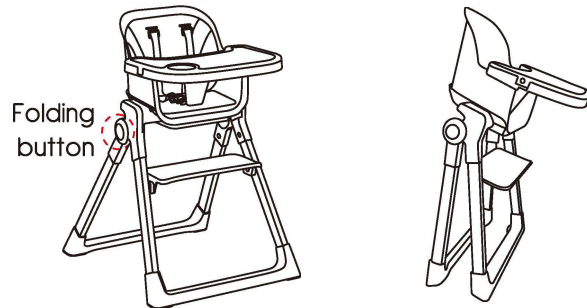

2. 2 Position removable tray with cover

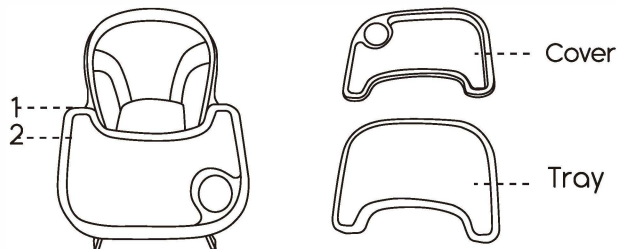

3. 2 Position footrest

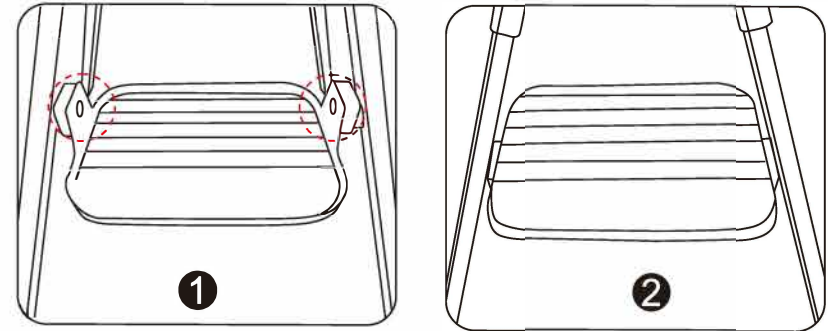

Press buttons on both sides to adjust footrest to each position.

4. Booster Mode

Booster mode: Suitable for children able to sit up unaided and up to 3 years or a maximum weight of 15 kg.

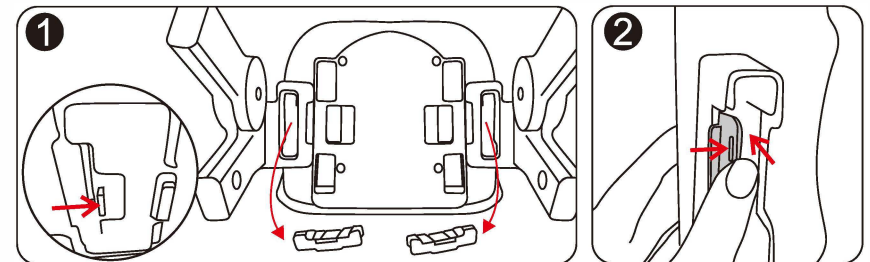

Push in.

Remove the two clasps.

Push the locking clips inwards to release the seat.

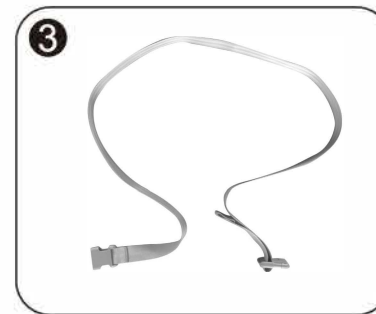

Place the seat on an adult chair, ready to install the booster chair safety belt.

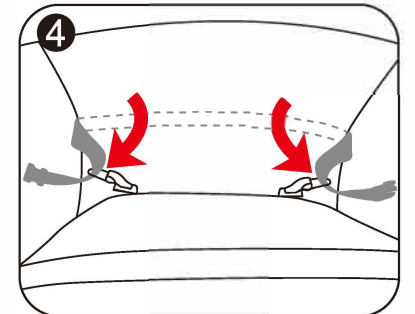

Loop the belt around the back of the adult chair. Then pass the ends of the belt through the D rings on the back of the booster.

IMPORTANT NOTE

Pay attention to the routing of the belt around the back of the adult chair

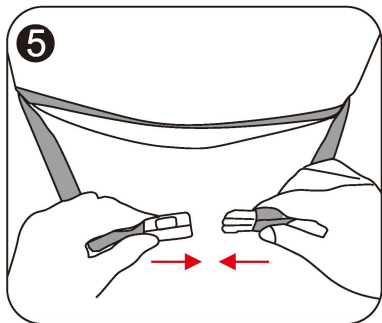

Fasten the seat belt behind the back of the adult chair.

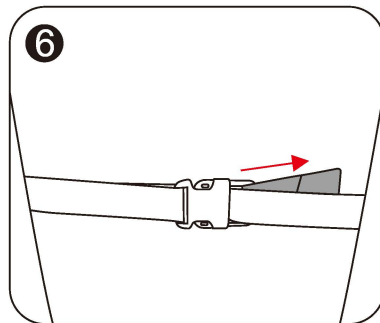

Tighten the belt to secure it.

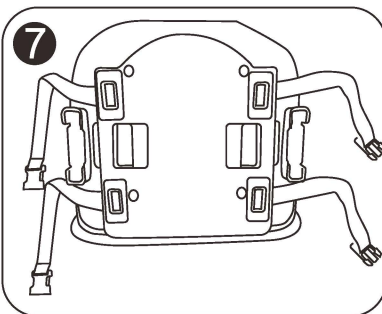

Insert all rectangular buckles through the bottom holes, then pull and tighten the belts to securely fasten the booster seat.

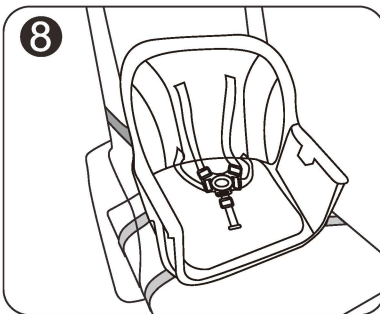

Booster mode complete.

Minimum adult chair size

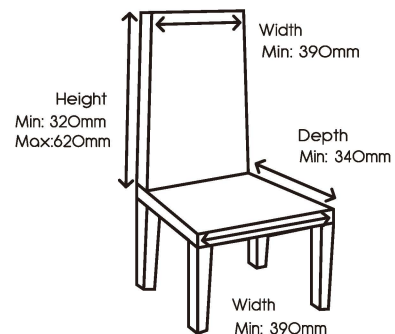

5. Stool Mode

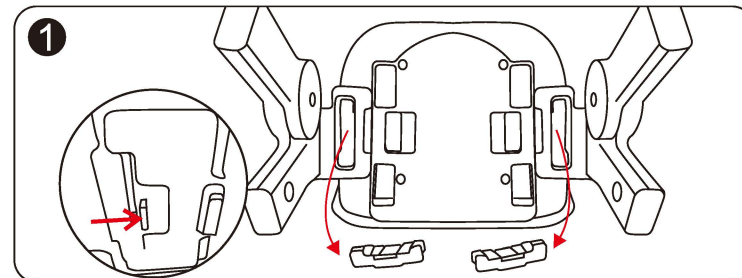

Push in. Remove the two clasps.

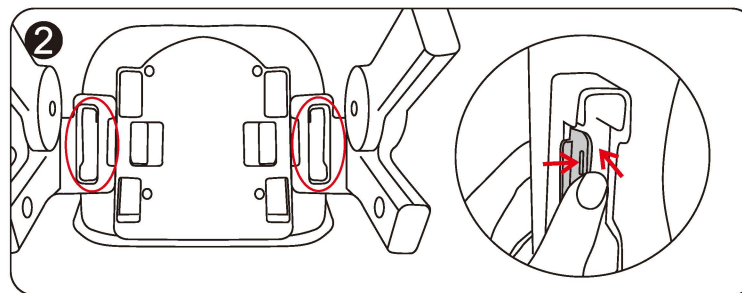

Push the locking clips inwards to release the seat.

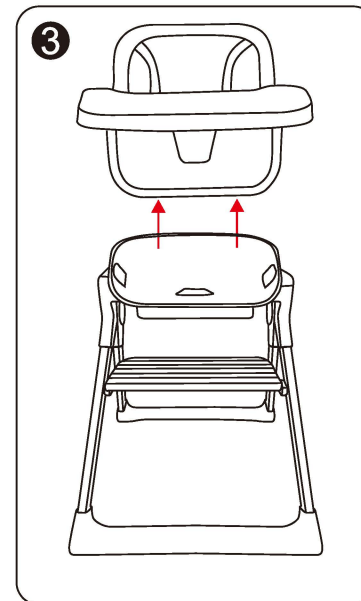

Remove the seat.

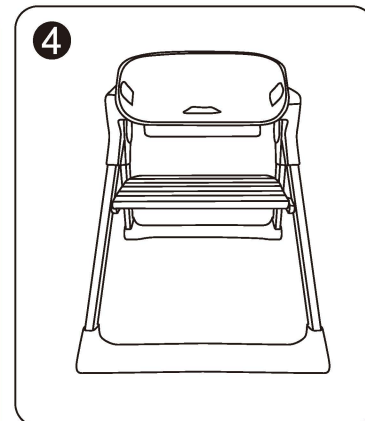

Stool mode complete.

Stool mode: Suitable for children over 3 years up to a maximum weight of 75 kg.