

red kite

IMPORTANT READ CAREFULLY AND KEEP FOR FUTURE REFERENCE

Instruction Leaflet

Push Me Pace i

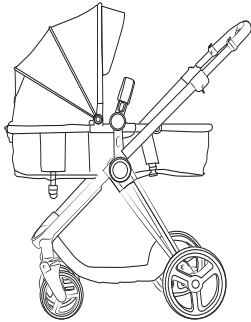

Pram Mode

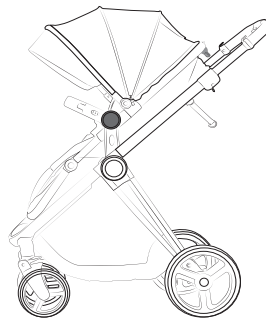

Stroller Mode

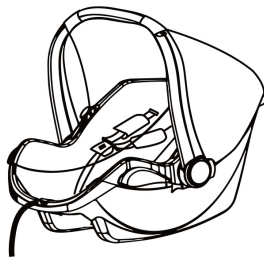

Infant Carrier

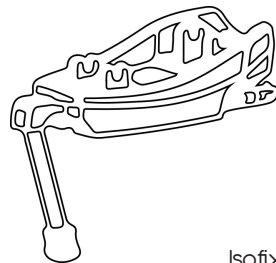

Isofix Base*
*Sold separately

Stroller: EN 1888-2:2018+A1:2022.

Carry Cot Mode: This product is suitable for a child who cannot sit up unaided, roll over and cannot push itself up (up to 9kg) on its hands and knees. Maximum weight of the child: 9kg.

Stroller Mode: Intended for children from 6 months up to 22kg or 4 years whichever comes first.

Rear Facing Infant Carrier: R129 Universal. For infants up to 13kg. Category: 40 – 85 cm.

Customer Care Line: 01454 326 568

Parts List

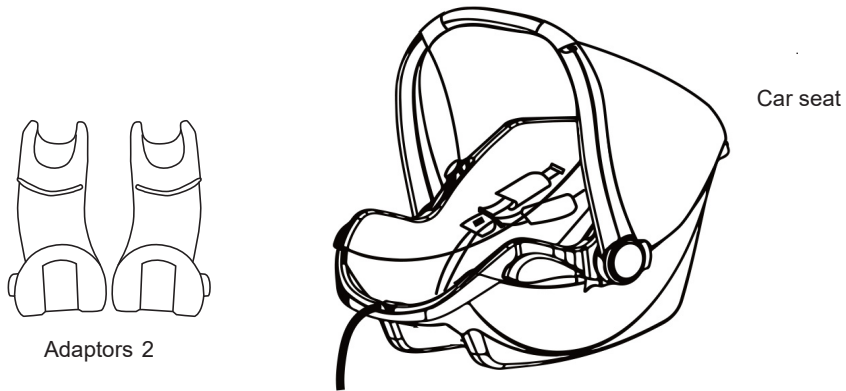
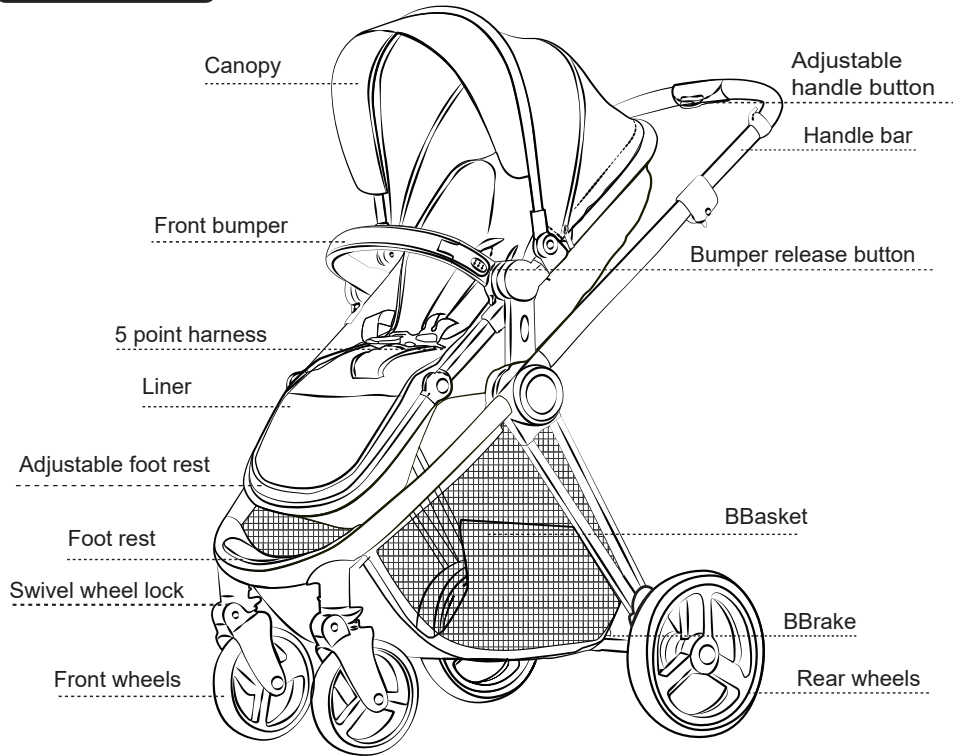

Parts List Ctd

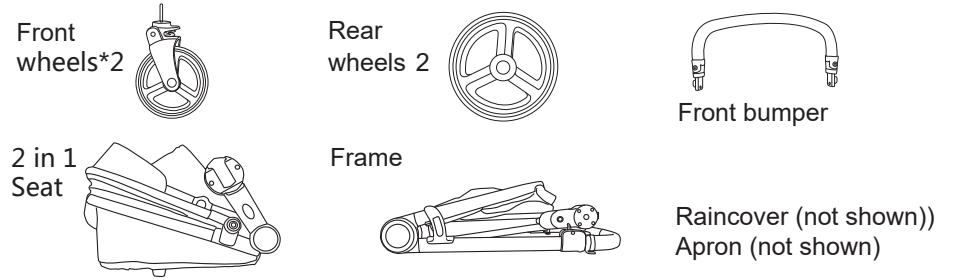

Assembly Instructions

To open the frame

1. Release the lock clip on the side of the frame (fig 1a), lift the handle upwards (fig 1b) until it locks in place. Fig 1c.

WARNING Ensure that all the locking devices are engaged before use.

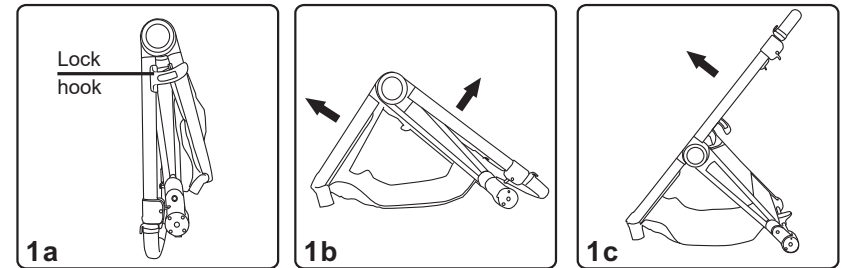

To attach the wheels

2. Push the metal stems of the front wheels upwards into the front wheel holders until they click in place. Fig 2. Pull gently to ensure the wheel is locked in place.

3. To remove the wheel, press in the top button and pull the wheel out. Fig 3.

4. Insert the metal stem of the rear wheel into the end of the brake unit until it clicks in place. Pull gently to ensure the wheel is locked in place. To remove the rear wheel, press the button on the bottom of the brake unit and pull the wheel out. Fig 4.

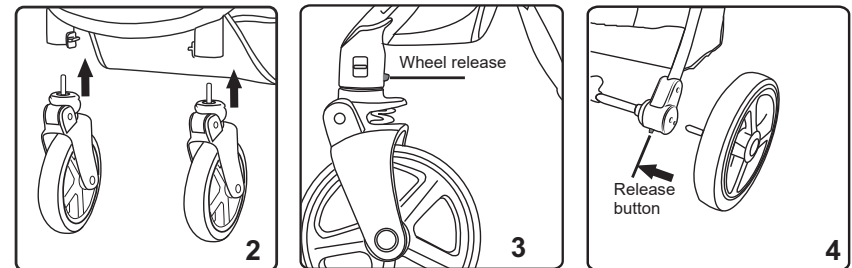

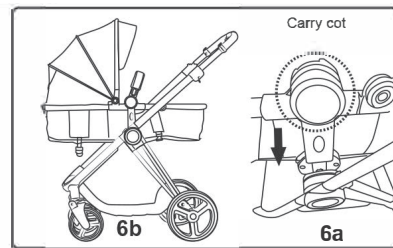
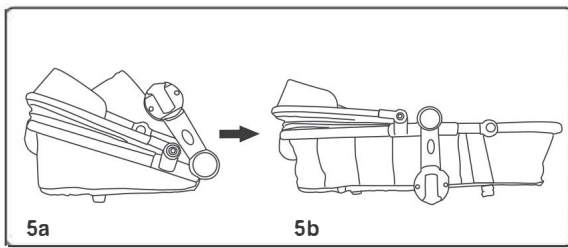

To assemble and attach the carry cot (Pram mode for babies up to 6 months)

5. Rotate the adaptors clockwise and then rotate the bottom frame section clockwise until it locks in place. Figs 5a and 5b.
6. With the adaptors in a vertical position, slide them on to the main pram frame until it clicks in place. Figs 6a and 6b.
7. Push the ends of the bumper bar into the recess on the seat frame until it clicks in place. To remove the bumper, press the buttons on the side and pull outwards. Figs 7a and 7b.

To adjust the handle height

8. Press and hold in the button on the top of the handle and choose which of the 3 positions you need. Fig 8.

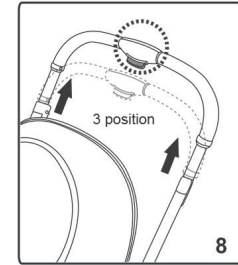
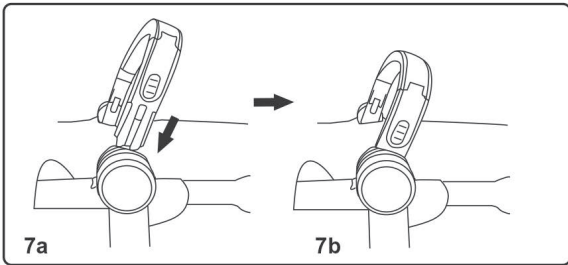

To secure and adjust the harness

Slide A on to B and then push into C to attach the harness. Press the button in the centre of the crotch strap (C) to release the harness. Adjust the waist and shoulder straps by means of the slides to achieve a snug comfortable fit. Figs 9.

WARNING Always use the crotch strap in combination with the waist belt.

Whilst in Pram Mode, the harness straps can be removed if needed. Undo the zips on the back of the seat, slide your hand inside to locate the buckles. Turn the buckles 90 degrees and push through the slots.

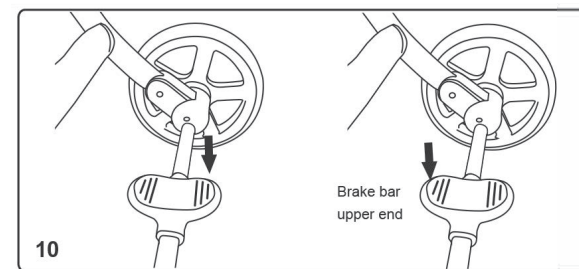
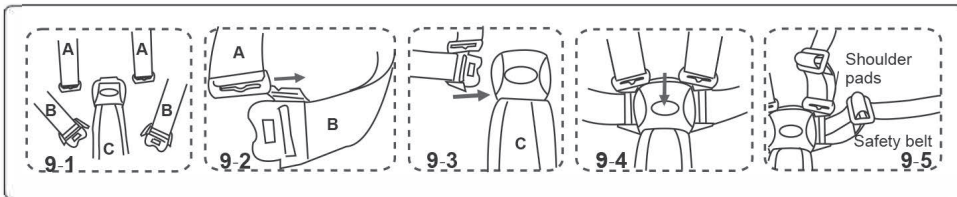

To use the brakes

10. Press the foot pedal forwards or backwards to engage or release the brakes. Fig 10.

WARNING Apply all the brakes whenever you park the stroller.

To select fixed or swivel front wheels

11. Press the button down to select a fixed wheel and pull it up for swivel wheels. Fig 11.

To adjust the footrest

12. Press in the buttons on both sides of the frame to adjust the footrest. Fig 12.

Seat unit removal, reversal and functions

13. Press in the buttons on the bottom of the adaptors on both sides to lift the seat unit/carry cot off the frame, turn the seat 180 degrees and reattach. Fig 13.

To use in stroller mode (for babies from 6 months +)

WARNING This seat unit is not suitable for children under 6 months.

14. Connect the buckles together on the foot end under the seat unit. Hold the D ring on the end of the recline strap and push the block forward. Fig 14.
15. Press the button on the back of the frame just behind the hood to select 1 of 3 different positions. Fig 15. The seat angle can be further adjusted by releasing the recline strap on the back of the seat.

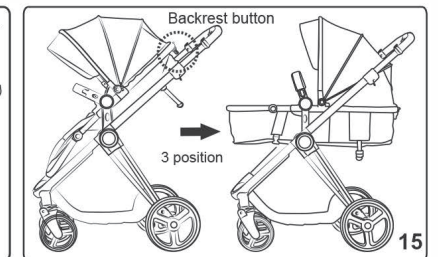
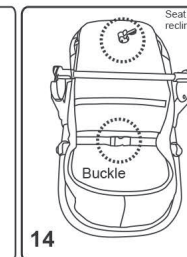
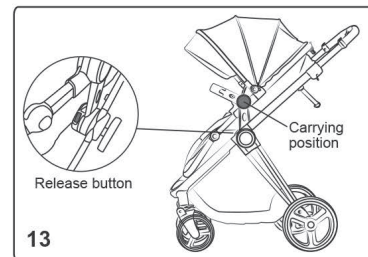

To fold the pushchair

16. Before folding, set the wheel locks to 'swivel'. Press in the button on the back of the seat unit and rotate the seat unit all the way forward. Fig 16a. Lower the handle height. Fig 16b. Press in the primary button on the right-hand side of the folding locks and pull both triggers toward you to fold the handle down then lift the bar across the centre to engage to locking hook. Figs 16c and 16d.

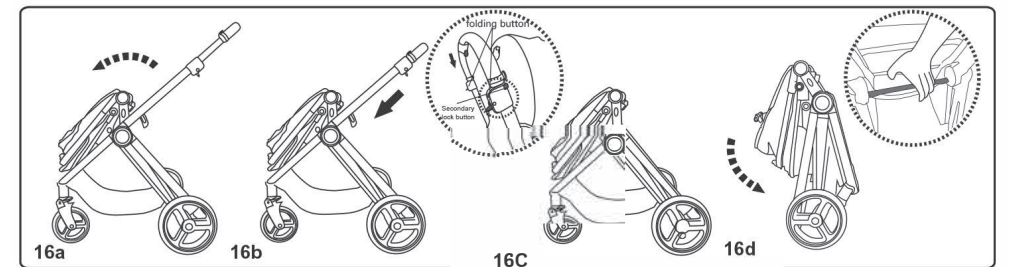

To attach and detach the car seat from the stroller chassis

Parts

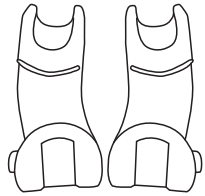

Adaptors x 2

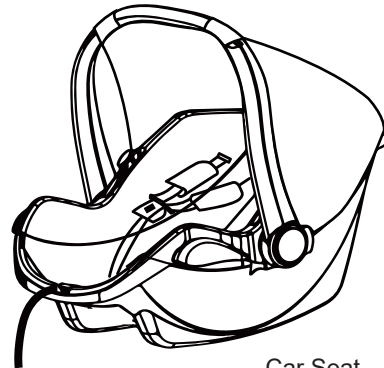

Car Seat

Assembly Steps

17. Insert the adaptors onto the pushchair frame until they click in place. Pull each adaptor upwards to ensure they're locked in place. Fig 17.

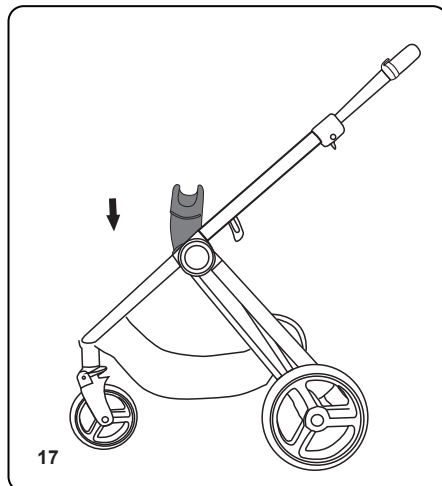

17

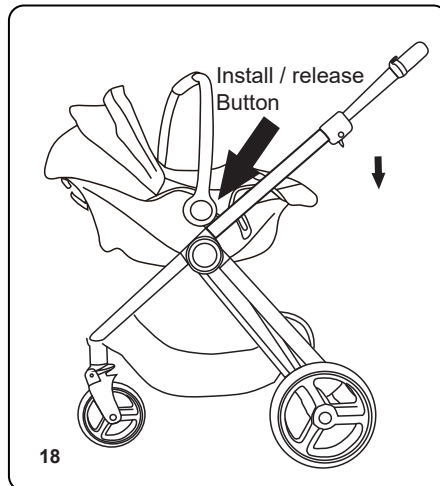

18

18. Lower the car seat gently onto the adaptors. Press the adaptor install/release button and simultaneously press the car seat down until it clicks in place. Repeat for the other side. Try to lift the car seat off the frame with the handle to ensure it's fully locked in place. Fig 18.

Detachment Steps

19. To release the car seat from the adaptors, press each of the release buttons and lift the car seat upwards. Fig 19.

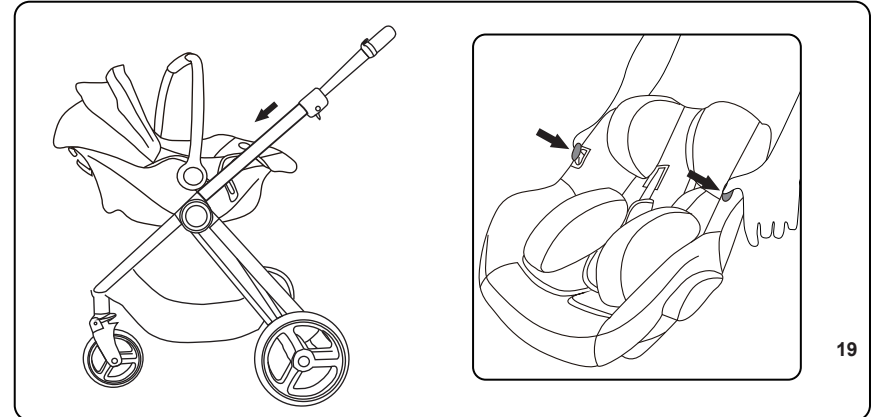

19

20. To release the adaptors from the pushchair frame, press in the button on each adaptor and pull upwards. Fig 20.

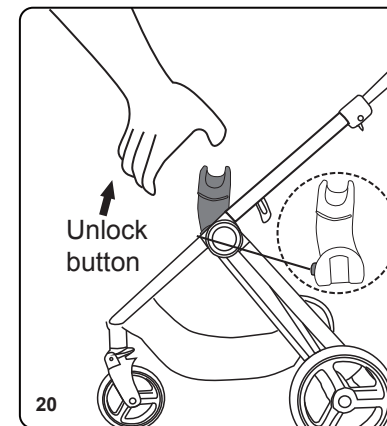

20

NOTE. You may remove the car seat with the adaptors and leave them in situ on the car seat if required.

⚠ WARNING

- Please ensure all of the locking devices are in locked positions, before use.
- **WARNING** Check that the car seat attachment devices are correctly engaged before use.
- This vehicle does not replace a cot or a bed, should your child need to sleep, then it should be placed in a suitable pram body, cot or bed.

General care:

- The correct use and maintenance of this stroller is essential.
- Do not use excessive force when folding the stroller.
- If you are having problems, fully open the stroller and repeat the folding procedure.
- Always let wheels down as gently as possible when mounting and dismounting kerbs.
- Always fold the stroller when going up or down stairs.
- Never bump the stroller over these or similar obstacles.
- In some climates mould and mildew can affect the fabric and rain cover. To avoid this, do not fold the stroller when it is wet. Leave it open in a ventilated area until completely dry.
- Always store the stroller in a dry place.
- When storing the stroller in the car, never place other items on top of it.
- Do not exceed the maximum load of 2 kgs in the shopping basket. (Where provided).

Cleaning:

- Fabric covers and trims may be spot washed using mild detergent and warm water. Leave to dry in a ventilated area away from direct sunlight.
 - Avoid leaving your stroller in direct sunlight for prolonged periods of time as this may cause fabrics to fade.
 - Do not dry clean, machine wash or tumble dry.
 - Metal parts may be cleaned with a damp cloth.
 - Always wipe dry. Clean plastic parts with a mild soap and water solution, wipe dry.
- Maintenance:
- Maintain your stroller by lubricating all metal moving parts with a silicone based spray. Do not use heavy machine oil or grease as this can attract dirt or grit.
 - Check that nothing is loose or broken and that no sharp edges have been exposed. Inspect all joints and the harness, replace any damaged parts immediately.
 - Inspect any nuts and bolts regularly to ensure none have worked loose. Tighten as necessary.
 - Only use replacement parts and accessories that have been approved by the manufacturer. Failure to do this may invalidate your warranty.

Safety warnings:

WARNING Never leave your child unattended.

WARNING To avoid injury ensure your child is kept away when unfolding and folding this product.

WARNING Do not let your child play with this product.

WARNING Always use the restraint system.

WARNING This product is not suitable for running or skating.

WARNING Your child's safety is your responsibility.

WARNING Any load attached to the handle affects the stability of the pram / pushchair.

WARNING Check that the pram body or seat unit or car seat attachment devices are correctly engaged before use.

• **WARNING** Use a harness as soon as your child can sit unaided.

• **PRAM MODE: WARNING:** This product is suitable for a child who cannot sit up by itself, roll over and cannot push itself up on its hands and knees. Maximum weight of the child: 9kg.

• Not intended for children weighing more than 22kgs.

This stroller is designed for one child only.

• The brake must always be engaged when placing and removing children from the stroller.

• Any load attached to the handle and/or on the backrest and/or on the sides of the vehicle will affect the stability of the stroller.

• Lift a child in and out of the stroller. Do not allow a child to stand on the footrest or seat.

• Do not use accessories that have not been approved by the manufacturer.

• Never use the stroller to carry a child up and down stairs or escalators.

EN 1888-2:2018+A1:2022

For all technical queries please call: 01454 326 568

Manufactured by: The Red Kite Baby Co Ltd, 35 Lavenham Road, Beeches Industrial Estate, Yate, Bristol, BS37 5QX. UK.

Stroller / Travel System Important Safety Information:

- For new born babies we recommend using the stroller in Pram mode as this provides the most reclined seat back position.
- Seat unit intended for children from 6 months up to 22 kg. Use in pram mode for babies aged 0 - 6 months and in stroller mode from 6 months until 22 kg or 4 years of age (whichever comes first).
- This product is supplied with one raincover which fits the stroller in stroller, pram and car seat mode. Place the raincover over the unit and secure with Velcro. We recommend allowing the raincover to dry before folding and storing in the basket to prevent mould and mildew forming.
- A raincover is not supplied for the car seat.
- Padded liners are supplied with the seat unit and car seat. These can be removed by threading the harness through the slots in the liner.
- The fixed wheel function makes using the stroller on uneven terrain easier. However, the stroller must never be used on sand as this will severely damage the bearings in the wheels.
- The height of the shoulder straps can be adjusted by feeding the harness through the cut out holes located on the seat unit.
- Never use the detached seat unit (in pram mode) as a carry cot.
- Never change the seat unit into pram mode with your child in the seat unit.
- **WARNING!** When in pram mode, do not use an additional mattress.
- Take extra care in windy conditions.

• This vehicle does not replace a cot or a bed. Should your child need to sleep, then it should be placed in a suitable pram body, cot or bed.

Before folding the stroller check the following:

A Your child is clear of moving parts

B The rear brakes have been applied

C The front wheels are secured in the locked mode

D The seat unit or car seat has been removed

E All items have been removed from the basket

F Never attempt to close or fold the stroller with the child inside