

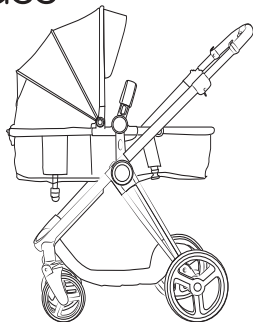

IMPORTANT
READ CAREFULLY AND KEEP
FOR FUTURE REFERENCE

Instruction Leaflet

Push Me Pace



Pram Mode

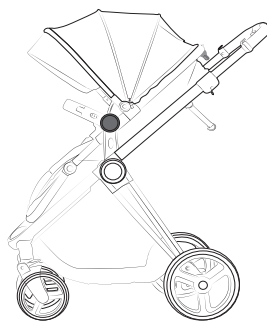

Stroller Mode

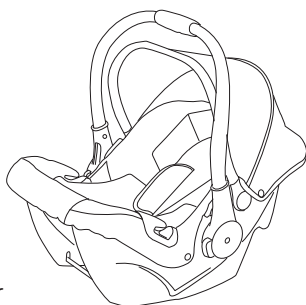

Infant Carrier

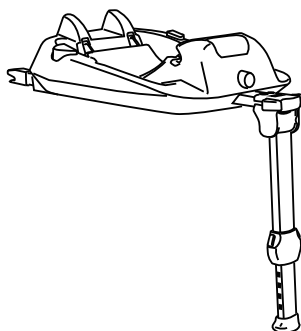

Isofix Base*

*Sold separately

Stroller: This vehicle is suitable (up to 22 kg or 4 years
(whichever comes first) Complies with EN 1888 – 2: 2018
Group 0+ Rear Facing Infant Carrier: For infants up to 13kg (Group 0+).
Conforms to ECE R44.04 Universal.
Customer Care Line: 01454 326 568

Parts List

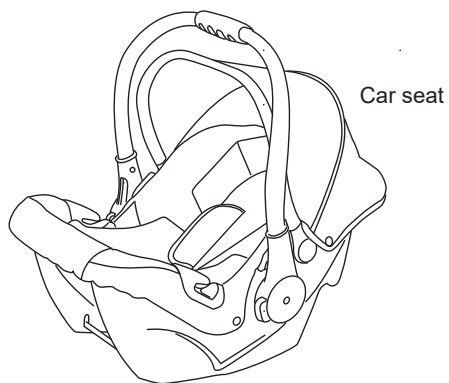
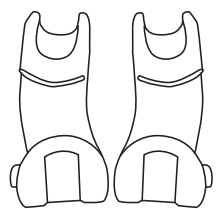
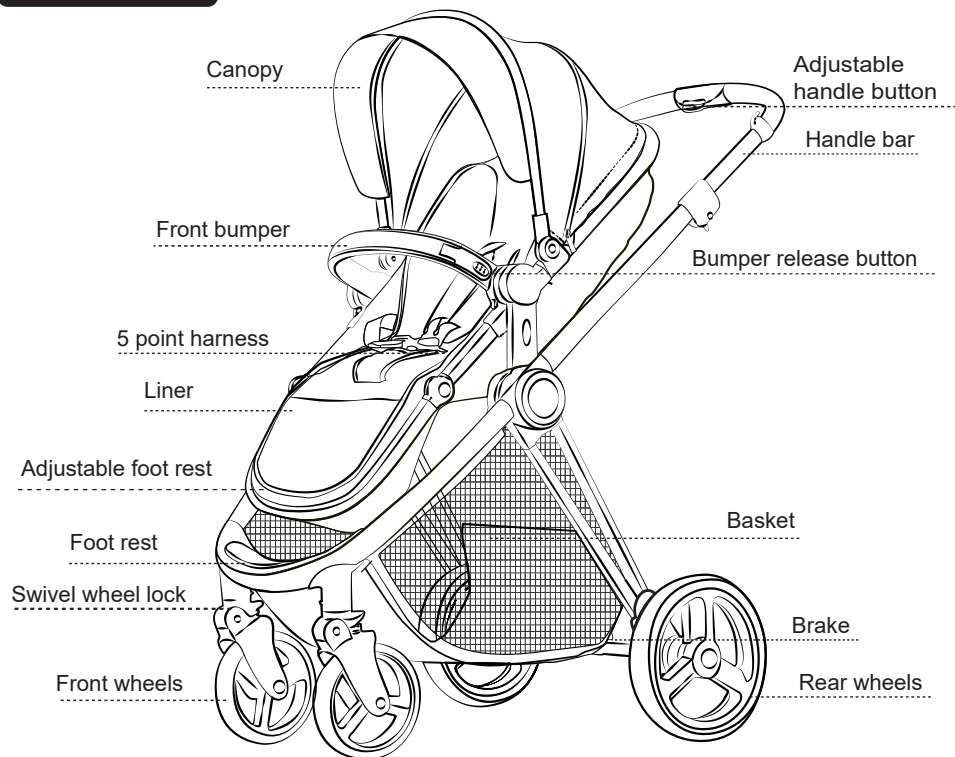

Parts List Ctd

Front wheels*2



Rear wheels*2

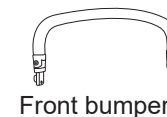

2 in 1 Seat

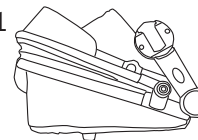

Frame

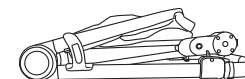

Raincover (not shown)

Assembly Instructions

To open the frame

1. Release the lock clip on the side of the frame (fig 1a), lift the handle upwards (fig 1b) until it locks in place. Fig 1c.

WARNING Ensure that all the locking devices are engaged before use.

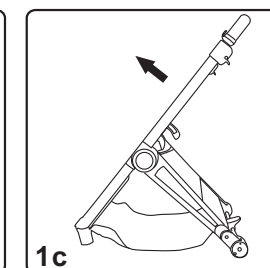
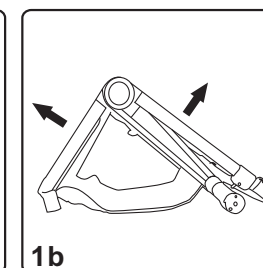
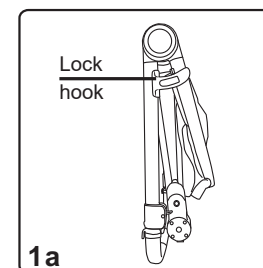

To attach the wheels

2. Push the metal stems of the front wheels upwards into the front wheel holders until they click in place. Fig 2. Pull gently to ensure the wheel is locked in place.

3. To remove the wheel, press in the top button and pull the wheel out. Fig 3.

4. Insert the metal stem of the rear wheel into the end of the brake unit until it clicks in place. Pull gently to ensure the wheel is locked in place. To remove the rear wheel, press the button on the bottom of the brake unit and pull the wheel out. Fig 4.

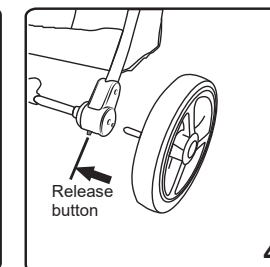
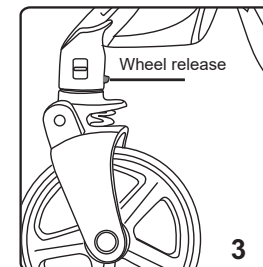
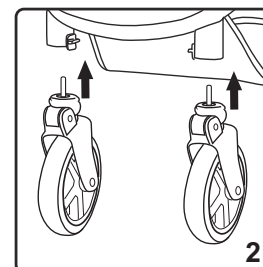

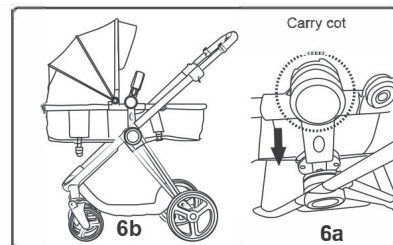
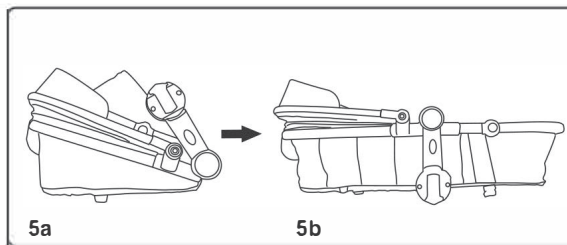

To assemble and attach the carry cot (Pram Mode: for babies from 0 - 6 months)

5. Rotate the adapters clockwise and then rotate the bottom frame section clockwise until it locks in place. Figs 5a and 5b.

6. With the adapters in a vertical position, slide them on to the main pram frame until it clicks in place. Figs 6a and 6b.

7. Push the ends of the bumper bar into the recess on the seat frame until it clicks in place. To remove the bumper, press the buttons on the side and pull outwards. Figs 7a and 7b.

To adjust the handle height

8. Press and hold in the button on the top of the handle and choose which of the 3 positions you need. Fig 8.

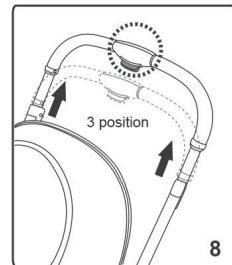
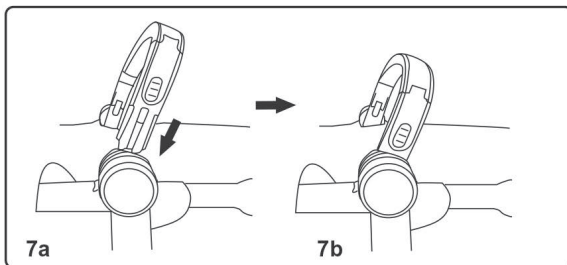

To secure and adjust the harness

9. Slide A on to B and then push into C to attach the harness. Press the button in the centre of the crotch strap (C) to release the harness. Adjust the waist and shoulder straps by means of the slides to achieve a snug comfortable fit. Figs 9.

WARNING Always use the crotch strap in combination with the waist belt.

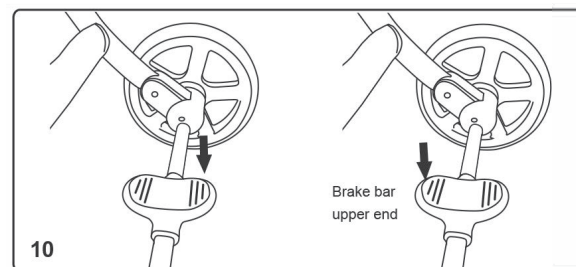
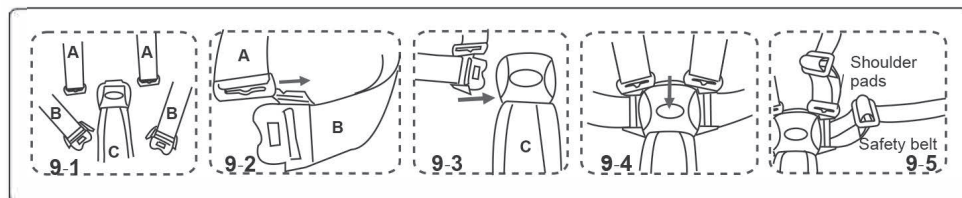

To use the brakes

10. Press the foot pedal forwards or backwards to engage or release the brakes. Fig 10.

WARNING Apply all the brakes whenever you park the stroller.

To select fixed or swivel front wheels

11. Press the button down to select a fixed wheel and pull it up for swivel wheels. Fig 11.

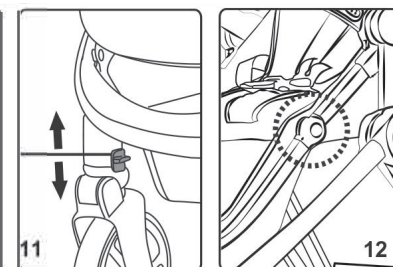

To adjust the footrest

12. Press in the buttons on both sides of the frame to adjust the footrest. Fig 12.

Seat unit removal, reversal and functions

13. Press in the buttons on the bottom of the adapters on both sides to lift the seat unit/carry cot off the frame, turn the seat 180 degrees and reattach. Fig 13.

To use in stroller mode (for babies from 6 months +)

WARNING This seat unit is not suitable for children under 6 months.

14. Connect the buckles together on the foot end under the seat unit. Hold the D ring on the end of the recline strap and push the block forward. Fig 14.

15. Press the button on the back of the frame just behind the hood to select 1 of 3 different positions. Fig 15. The seat angle can be further adjusted by releasing the recline strap on the back of the seat.

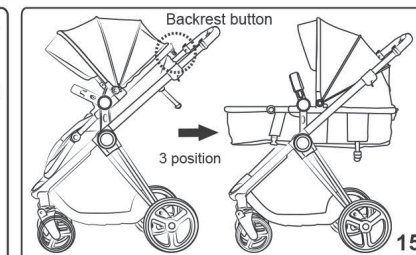
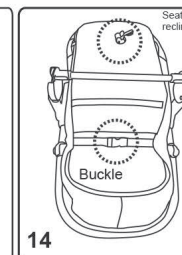
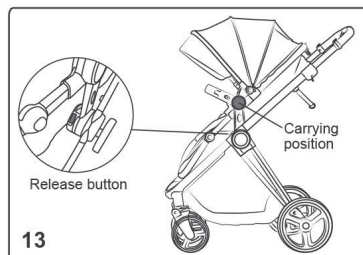

To fold the pushchair

16. Press in the button on the back of the seat unit and push the seat unit all the way forward. Fig 15a. Lower the handle height. Fig 15b. Press in the primary button on the right-hand side of the folding locks and pull both triggers toward you to fold the handle down then lift the bar across the centre to engage to locking hook. Figs 15c and 15d.

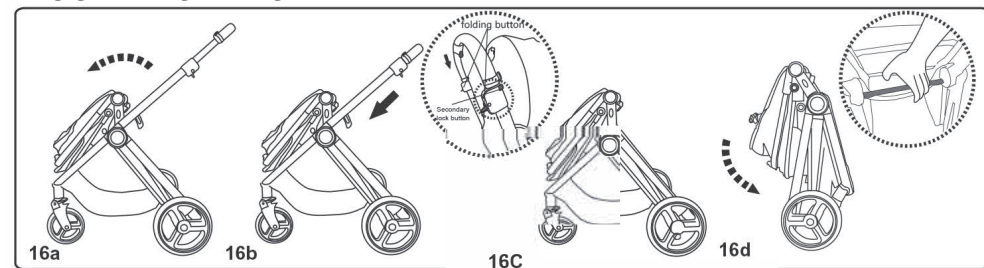

Infant Carrier instructions

Adjusting the handle

2a There are 4 positions: In vehicle position (D), Carry position (A), Middle position (B) and Stationary position (C).

2b To adjust, squeeze the handle release buttons on both sides, then rotate the handle. The handle will lock into position.

2c You should hear a click when the handle button is engaged and the handle is locked into the upright carrying position.

WARNING! Always make sure the handle is securely locked in the upright position before carrying.

Adjusting the harness

3a Adjust the shoulder straps height so they are level with, or just below the child's shoulders.

3b To change the slot in which the shoulder straps are in, remove the straps from the central buckle by pressing the button. Pull both straps through the cover and seat shell.

3c Thread the harness straps through the desired harness slot. Make sure both straps are even in length and not twisted. Secure the harness strap into the central buckle. Pull to make sure the harness straps are firmly secured in the buckle. It is very important to remember that shoulder straps should be level with, or just below the child's shoulders (3a).

Securing the child in the child restraint

4a Press the adjuster button on the front centre of the seat and pull both shoulder straps to loosen the harness.

4b Press the red button on the buckle to release the shoulder straps and remove them to the side.

4c Place child's bottom on the seat and the child's back flat against the back of the child restraint. This will be the most comfortable position and allow the harness to properly secure the child. Slide the shoulder straps over the child's shoulders. Again, make sure the harness is positioned below the top of the child's shoulders.

4d Align the top and bottom buckle prongs to form one prong.

4e Insert the joined up prong into the buckle until you hear a "Click". Ensure the shoulder straps are not twisted. Adjust the shoulder pads over the centre of the child's shoulders.

4f Pull the harness adjustment strap until the shoulder straps are secured snugly against the child.

4g For correct tightness, one finger should fit between the harness straps and the child's shoulders.

To remove the child from the infant carrier, loosen the shoulder straps and release the buckle.

Discontinue use when the child's weight is over 13kg, over 74cm in height, or the top of their head is less than 2cm from the top of the shell. Whichever is first.

Safe usage when not in the vehicle

ALWAYS secure the child with the harness when placing the child in the infant carrier.

ALWAYS make sure the handle is securely locked before lifting the infant carrier.

For use as an infant carrier, place the handle in carrying position (A in 2a).

For rocking mode, place the infant carrier on level ground, make sure the handle is in carrying position (A in 2a) and rock gently.

For resting position, place the infant carrier on a secure and level floor surface, and put the handle in the stationary position (C in 2a).

To install the infant carrier in the vehicle

WARNING! Do not use a 2 point vehicle belt to install this car seat.

WARNING! Only install this rear facing infant carrier on forward facing vehicle seats.

Make sure the child is properly secured in the infant carrier and the infant carrier is tightly installed in the vehicle.

5a Place the rear facing infant carrier on the vehicle seat and make sure the handle is in the specified position. The child will face the rear of the vehicle.

5b Route the vehicle lap belt through both lap belt guides on the infant carrier and buckle the seat in place.

5c-d Route the vehicle shoulder belt around the back of the infant carrier and through the shoulder belt guide.

If the vehicle shoulder strap is too short, please move the vehicle seat as far back as possible and lower the vehicle seat belt height. If the vehicle belt is still too short, try another seating position in the vehicle.

5e Adjust the child restraint to the proper recline to ensure maximum protection for the child. A tightly rolled towel under the front edge of the infant carrier can be used to achieve the correct recline.

To remove the cover

6a-b Unscrew the lap belt guides by unscrewing them from underneath and pull the cover off of the shell.

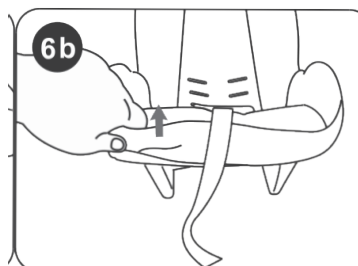
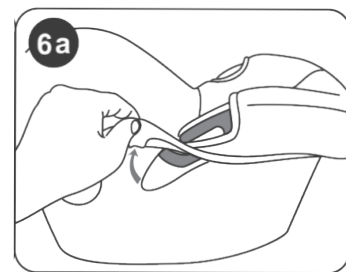
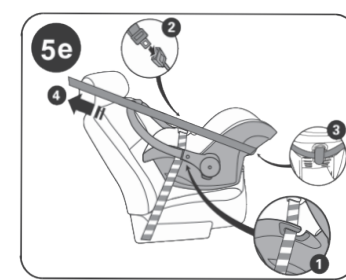
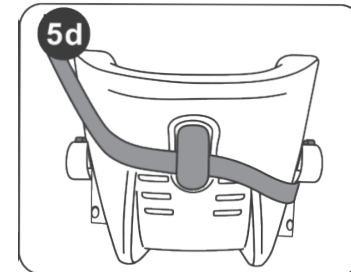
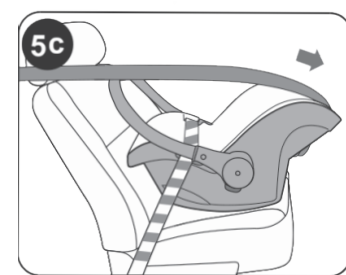
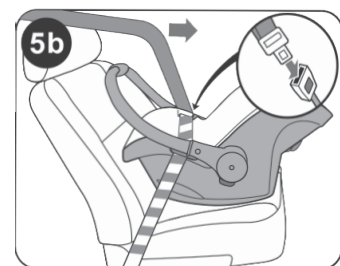
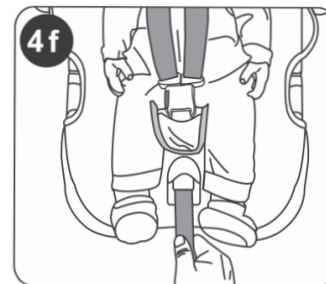
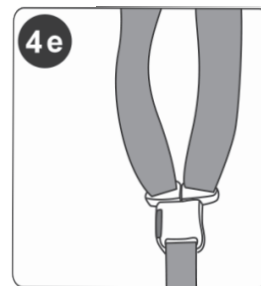
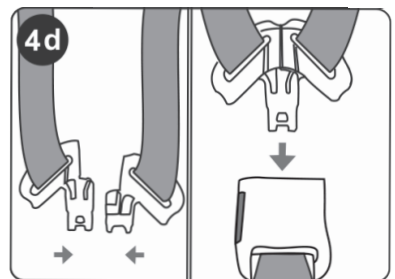
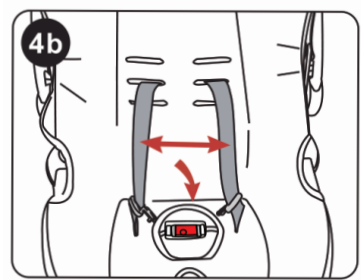
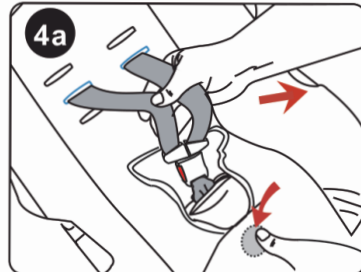
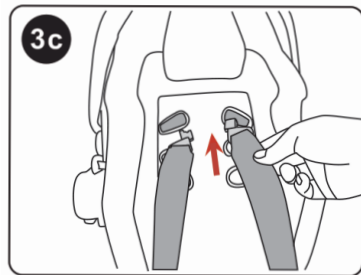
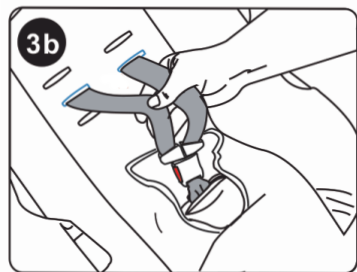
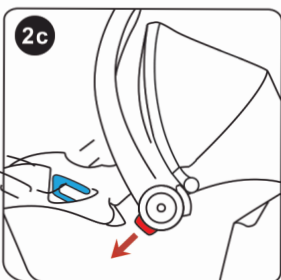
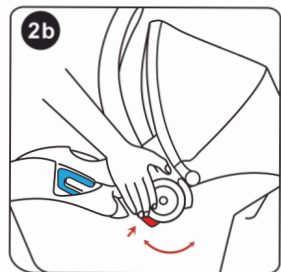
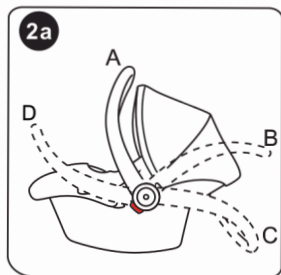

Isofixbase instructions

To install the Isofix base into the car

1. Pull the support leg downwards until it is vertical. Push the button on the front of the base and push forward on the top of the leg to extend the Isofix locking catches.

Fig 1.

2. Locate the Isofix anchorage points in the seat of your car and push the catches of the base firmly on to these points.

Fig 2.

3. Adjust the height of the support leg by squeezing the buttons on the sides until the leg is firmly on the ground.

Fig 3.

To attach the car seat to the base

4. With the car seat facing rearwards, insert it on to the Isofix base and push down until it clicks in place.

Fig 4.

5. Rotate the car seat handle forward. Push the button on the front of the base and push the base forward until it fits snugly against the seat back rest of the car.

Fig 5.

NOTE. If leaving the Isofix base in the car, this will be the only time you would need to adjust it.

To release the car seat from the base

6. Rotate the car seat handle to the carrying position. Push the release button on either side of the base and lift the car seat off the Isofix base.

Fig 6.

To remove the Isofix base

7. Pull the levers on the top of the support leg to remove the Isofix base from the car and fold the leg up.

Fig 7.

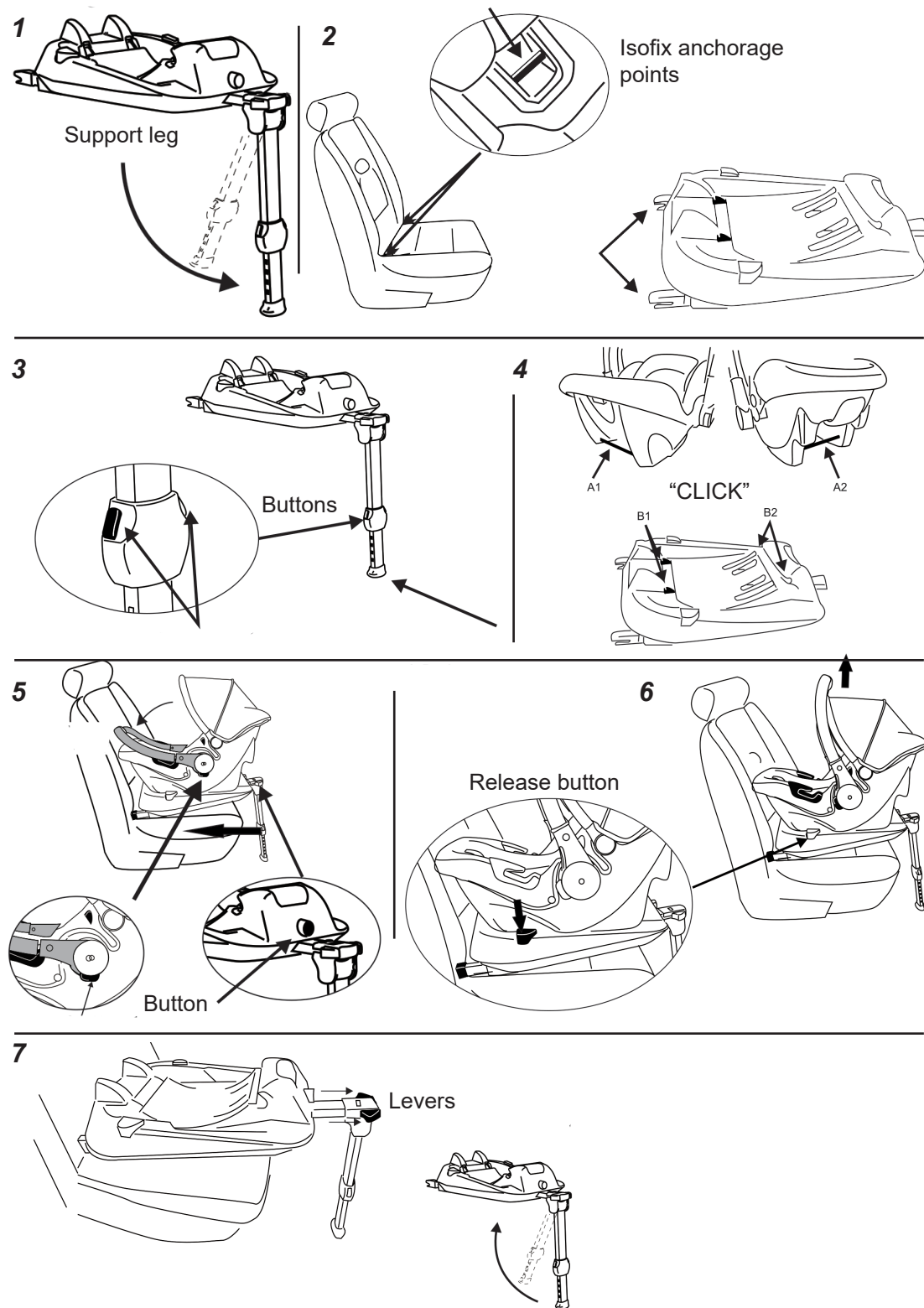

General care:

- The correct use and maintenance of this stroller is essential.
- Do not use excessive force when folding the stroller.
- If you are having problems, fully open the stroller and repeat the folding procedure.
- Always let wheels down as gently as possible when mounting and dismounting kerbs.
- Always fold the stroller when going up or down stairs.
- Never bump the stroller over these or similar obstacles.
- In some climates mould and mildew can affect the fabric and rain cover. To avoid this, do not fold the stroller when it is wet. Leave it open in a ventilated area until completely dry.
- Always store the stroller in a dry place.
- When storing the stroller in the car, never place other items on top of it.
- Do not exceed the maximum load of 2 kgs in the shopping basket. (Where provided).

Cleaning:

- Fabric covers and trims may be spot washed using mild detergent and warm water. Leave to dry in a ventilated area away from direct sunlight.
 - Avoid leaving your stroller in direct sunlight for prolonged periods of time as this may cause fabrics to fade.
 - Do not dry clean, machine wash or tumble dry.
 - Metal parts may be cleaned with a damp cloth.
 - Always wipe dry. Clean plastic parts with a mild soap and water solution, wipe dry.
- Maintenance:
- Maintain your stroller by lubricating all metal moving parts with a silicone based spray. Do not use heavy machine oil or grease as this can attract dirt or grit.
 - Check that nothing is loose or broken and that no sharp edges have been exposed. Inspect all joints and the harness, replace any damaged parts immediately.
 - Inspect any nuts and bolts regularly to ensure none have worked loose. Tighten as necessary.
 - Only use replacement parts and accessories that have been approved by the manufacturer. Failure to do this may invalidate your warranty.

Safety warnings:

WARNING Never leave your child unattended.

WARNING To avoid injury ensure your child is kept away when unfolding and folding this product.

WARNING Do not let your child play with this product.

WARNING Always use the restraint system.

WARNING This product is not suitable for running or skating.

WARNING Your child's safety is your responsibility.

WARNING Any load attached to the handle affects the stability of the pram / pushchair.

WARNING Check that the pram body or seat unit or car seat attachment devices are correctly engaged before use.

- **WARNING** Use a harness as soon as your child can sit unaided.

- **PRAM MODE:** **WARNING:** This product is suitable for a child who cannot sit up by itself, roll over and cannot push itself up on its hands and knees. Maximum weight of the child: 9kg.

- Not intended for children weighing more than 22kgs. This stroller is designed for one child only.
- The brake must always be engaged when placing and removing children from the stroller.
- Any load attached to the handle and/or on the backrest and/or on the sides of the vehicle will affect the stability of the stroller.
- Lift a child in and out of the stroller. Do not allow a child to stand on the footrest or seat.
- Do not use accessories that have not been approved by the manufacturer.
- Never use the stroller to carry a child up and down stairs or escalators.

This product complies with EN 1888 - 2 : 2018

For all technical queries please call: 01454 326 568

Imported by: The Red Kite Baby Co Ltd, 35
Lavenham Road, Beeches Industrial Estate, Yate,
Bristol, BS37 5QX

Stroller / Travel System Important Safety Information:

- For new born babies we recommend using the stroller in Pram mode as this provides the most reclined seat back position.
- Seat unit intended for children from 6 months up to 22 kg. Use in pram mode for babies aged 0 - 6 months and in stroller mode from 6 months until 22kg or 4 years of age (whichever comes first).
- This product is supplied with one raincover which fits the stroller in stroller, pram and car seat mode. Place the raincover over the unit and secure with Velcro. We recommend allowing the raincover to dry before folding and storing in the basket to prevent mould and mildew forming.
- Araincover is not supplied for the car seat.
- Padded liners are supplied with the seat unit and car seat. These can be removed by threading the harness through the slots in the liner.
- The fixed wheel function makes using the stroller on uneven terrain easier. However, the stroller must never be used on sand as this will severely damage the bearings in the wheels.
- The height of the shoulder straps can be adjusted by feeding the harness through the cut out holes located on the seat unit.
- Never use the detached seat unit (in pram mode) as a carry cot.
- Never change the seat unit into pram mode with your child in the seat unit.
- WARNING!** When in pram mode, do not use an additional mattress.
- Take extra care in windy conditions.

•This vehicle does not replace a cot or a bed. Should your child need to sleep, then it should be placed in a suitable pram body, cot or bed.

Before folding the stroller check the following:

A Your child is clear of moving parts

B The rear brakes have been applied

C The front wheels are secured in the locked mode

D The seat unit or car seat has been removed

E All items have been removed from the basket

F Never attempt to close or fold the stroller with the child inside

Isfix Base Important Safety Information:

For the maximum protection and comfort of your child, it is essential that you read through the entire manual carefully and follow all instructions.

This base is classified for "Universal" use and is suitable for installing into the seat positions of the following cars: **IMPORTANT:** Seat positions in other cars may also be suitable to accept this child restraint. If in doubt, consult either the child restraint manufacturer or the retailer.

In case you want to check if your child restraint is installed correctly on the base, please release the car seat from the base and put it back on. If the indicator panel lights all turn green and audible feedback is given, your child restraint is installed correctly

Infant Carrier Important Safety Information

Read these instructions before fitting the car seat in your car or stroller so that you are familiar with it and avoid any potentially dangerous misuse.

The Pace group 0+ car safety seat has been subjected to all safety tests and is approved under European standard ECE R44/04, for children of weight from 0 to 13 kg

(0 to 12-15 months).

- **IMPORTANT:** The Pace group 0+ car seat, must be installed facing opposite to the normal forward movement of the car, on seats without airbags. Do not install the Pace group 0+ car seat on backward facing seats or seats arranged facing each other.
- **WARNING:** Read the instructions carefully before use and retain for future reference. Failure to closely follow the installation instructions for the car safety seat will put your child at risk.
- The assembly and installation operations must be conducted by adults.
- Avoid inserting fingers into the mechanisms.
- Install this group 0+ car safety seat facing opposite to the normal forward movement of the vehicle.
- Death or serious injury can result if this car safety seat is installed on seats with airbags.
- Eliminate danger by disabling airbags surrounding the position of the car safety seat.
- In the case of rotating or movable seats it is important to install this safety seat facing opposite to the normal forward movement of the vehicle.
- When traveling take special care to make sure that luggage or other objects do not injure the child in the safety seat in the case of accidents.
- Do not use installation methods different from those indicated. This would result in the risk of detachment from the seat.
- Car safety seat, group 0+, “Universal” approved under European standard ECE R44/04 for children of weight from 0 to 13 kg (0 to 12/15 months). Suitable for installation on the majority of vehicle seats, but not all.
- The car safety seat can be correctly installed if the vehicle’s use and maintenance manual indicates compatibility with “Universal” group 0+ restraint systems.
- This safety seat is classed as “Universal” in compliance with stricter approval criteria than previous models that do not have approval labels.
- The safety seat can only be used in approved vehicles, fitted with static or inertia-reel three-point seat belts, approved under regulation UN/ECE no. 16 or equivalent standards. It must not be used with two-point or lap seat belts.
- Ensure that the three-point car seat belt fixing the safety seat is always taut and not twisted. It should be replaced in the case of heavy stress as a result of an accident.
- Never leave the child unattended in the safety seat: observe him/her even when sleeping.
- Never remove the child from the seat while the vehicle is in motion.
- Make sure that the safety seat is protected from any mobile parts of the car seat or doors.
- To avoid the risk of falling always use the safety seat harness even for transport outside the vehicle. Adjust the height and tension of the straps ensuring that they are snug to the child’s body without constricting him/her too much. Check that the harness is not twisted and that the child does not release it.
- **NEVER** lift the car seat by the hood.

- This car safety seat is not designed for extended periods of sleep. The safety seat is not a substitute for a cot and if the child needs to sleep it is important to lie him/her down.
- Do not leave the car safety seat in the car exposed to the sun. Some parts might heat up and be harmful to the delicate skin of the child -check before placing the child in the seat.
- Do not use the safety seat without its fabric covering, which cannot be replaced with one not approved by the manufacturer since it is an integral part of the safety seat and the safety system.
- If in doubt refer to the manufacturer or retailer of the safety seat.
- Do not remove the adhesive and stitched labels since this might make the product non compliant with legal requirements.
- Do not use the safety seat if it has signs of breakage or missing parts, is second hand, or if it has been subjected to violent stress in an accident, because it might have suffered extremely dangerous structural damage.
- Do not modify the product.
- Do not use this car safety seat after five years from the date of production indicated on the structure. The natural aging of the materials may mean that it may no longer be compliant with standards.
- The use of the safety seat for premature infants born at less than 37 weeks could cause respiration problems for the infant seated in the safety seat. It is advisable to seek medical advice before leaving the hospital.
- Do not use accessories not approved by the manufacturer or by the competent authorities.
- To avoid the risk of falling, never place the safety seat on raised surfaces (tables, work surfaces) soft surfaces (beds, sofas) or sloping surfaces.

NOTICE

1. This is a “Universal” child restraint; it is approved to ECE Regulation 44.04 for general use in vehicles and will fit most, but not all, vehicle seats.
2. A correct fit is likely if the vehicle manufacturer has declared in the vehicle handbook that the vehicle is capable of accepting a “Universal” child restraint for this group.
3. This child restraint has been declared “Universal” under more stringent conditions than those applied to earlier designs which do not carry this notice.
4. If in doubt, consult either the child restraint manufacturer or the retailer.

Only suitable if the vehicle is fitted with 3-point static, 3-point retractor safety belts, approved to UN/ECE Regulation No. 16 or other equivalent standards.

EXTREME HAZARD

Do not use in passenger seats equipped with airbags (SRS).

The instructions for use should be kept for future reference.

The correct use and maintenance of your car seat will ensure it gives long and trouble free use.

When somebody else is using your car seat, ensure they also know how to use it, especially the correct way to adjust it. The safety of your child is your responsibility.

1. PLEASE READ THOROUGHLY BEFORE COMMENCING INSTALLATION AS AN INCORRECT INSTALLATION COULD BE DANGEROUS.
2. PARENTS SHOULD NOT UNDER ANY CIRCUMSTANCES USE THIS CHILD RESTRAINT ON A PASSENGER SEAT EQUIPPED WITH AN AIRBAG.
3. The child seat must only be installed in the rearward facing position.
4. Never use the child seat without fastening the child's harness correctly, and never attempt to use it without fastening it into the car as described in these fitting instructions, if the shoulder height is not ok, please reinstall the seat again.
5. It is most important that the seat belt is correctly routed and the child seat tightened down on the upholstery as firmly as possible to ensure maximum protection. A recommended method is shown in these instructions.
6. Do not add or modify this product in any way.
7. Never use this product if it has been in an accident, or if it has become badly worn. Periodically inspect the harness for wear, paying particular attention to attachment points, stitching and adjusting devices.
8. Do not leave a child in the seat unattended at any time.
9. Ensure that no part of the seat or seat belt is trapped in a door or a folding seat. If your car has a folding rear seat, ensure that it is correctly latched in its upright position.
10. Car interiors can become very hot when left standing in direct sunlight it is therefore recommended that the child seat, when not in use, is covered by a towel etc. This prevents components, particularly those attached to the child seat, becoming hot and burning the child.
11. In the event of an emergency it is important that the child can be released quickly. This means that the buckle is not fully tamperproof and therefore your child should be persuaded never to play with the buckle.
12. Luggage and other heavy objects should be secured in the car. Loose objects are liable to cause injury in the event of an accident.
13. The child seat must not be used without the cover.
14. Never place your child seat on a table or work surface.
15. This seat can be used for children of 0 - 13kg in weight and is used in conjunction with a 3-point lap and diagonal safety belt in the rear-facing position only.
16. When the child seat is not in use, it is recommended that it is fastened into the car with a seat belt to avoid cause injury in the event of an accident.
17. In an emergency your child can be released quickly by pressing the red button on the harness buckle.
18. Store this child seat in a safe place when it is not being used. Avoid placing heavy objects on top of it.
19. If you travel with passengers using both the front and rear passenger seats, the lighter occupants should be in the rear and the heavier occupants in the front of the vehicle.
20. Do not allow your child seat to come into contact with corrosive substances e.g. battery acid.
21. Do not leave the child seat with a child in it on a raised surface, such as a table work top, bed or shopping trolley, due to the risk of falling.
22. The manufacturer can only guarantee the safety of the seat if it is used by the original owner.
23. We strongly advise against using a second-hand product, as you can never be sure of its history.
24. Always check to make sure the seat fits in your car properly before purchasing it.